

# RADIAL VALVE UNLOADERS

Building upon the extremely efficient radial valve design, ACI's patented radial valve unloader provides cylinder end deactivation for slow, medium, and high-speed reciprocating compressors.



Often a single radial valve unloader is as efficient, or even more efficient, than two plug-type unloaders over standard, single deck valves.

Unlike plug-type and finger-type unloaders, when the radial unloader is in its loaded mode (cylinder end compressing gas), it efficiently is as high as the normal radial valve. Plug-type and finger-type unloaders always negatively affect the efficiency of the valve, even when not in use.

Fundamentally, the innovative radial valve design provides significantly more flow area per valve port than single deck designs. Compared with most double-deck designs, radial valves not only provide more flow area, but they incur less added fixed clearance.

Call ACI today for more information on how you can equip your compressors with the next generation of end deactivation - radial valve unloaders.

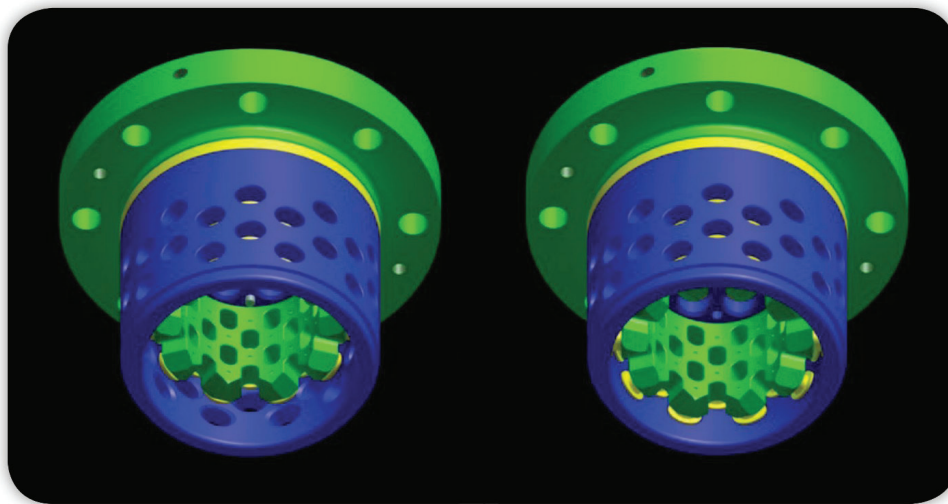

UNLOADED

LOADED

**LEGENDS DON'T STOP. WE MAKE SURE OF IT.™**

CALL +1 855-2COOPER | +1 740-435-0240  
24/7 TECH SUPPORT: SUPPORT@COOPERSERVICES.COM  
COOPERSERVICES.COM

